

DWG: F:\2020\3001-3500\020-3297\40-Design\Survey\SRV\Xref\V_XRWAY_0203297.dwg
 DATE: Jun 18, 2021 9:02am
 USER: sruizavitia
 XREFS: V_RWAY_SPM_72521 Norfolk-BASE

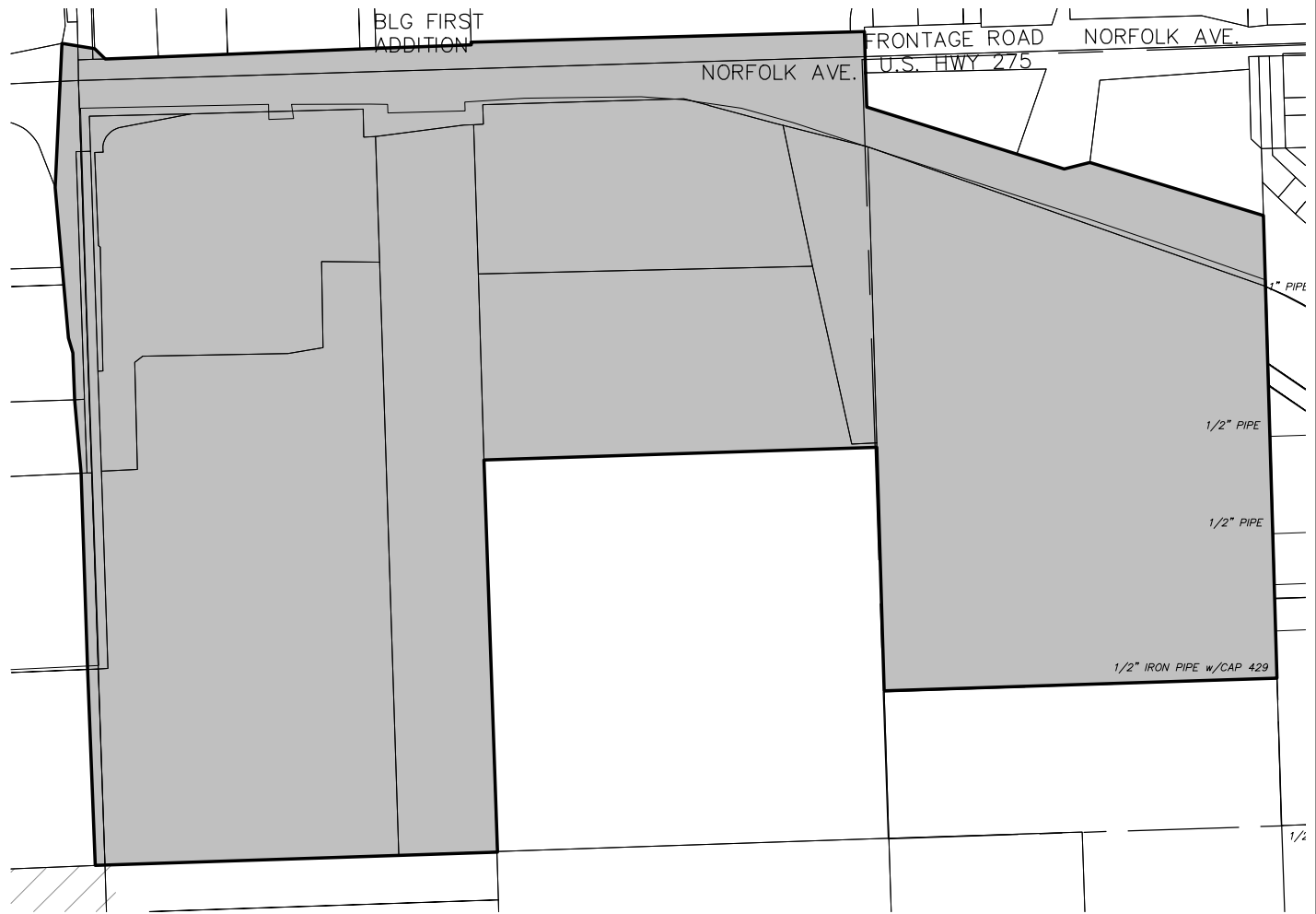

LEGAL DESCRIPTION

A TRACT IN PARTS OF SECTION 29-T24N-R1W OF THE 6TH P.M., NORFOLK, MADISON COUNTY, NEBRASKA AND MORE PARTICULARLY DESCRIBED AS FOLLOWS:

BEGINNING AT THE INTERSECTION OF THE NORTH RIGHT-OF-WAY LINE OF HIGHWAY 275 AND THE WEST RIGHT OF WAY LINE OF SOUTH 37TH STREET; THENCE EASTERLY, ALONG SAID NORTH RIGHT-OF-WAY LINE OF HIGHWAY 275 TO THE INTERSECTION OF SAID NORTH RIGHT OF WAY LINE OF HIGHWAY 275 AND EAST LINE OF THE WEST HALF OF THE NORTHEAST QUARTER THENCE SOUTH, ALONG SAID EAST LINE OF THE WEST HALF OF THE NORTHEAST QUARTER TO THE SOUTHEAST CORNER OF A TRACT OF LAND APPROXIMATELY 500 FEET NORTH OF THE SOUTHEAST CORNER OF THE SOUTHWEST QUARTER OF THE NORTHEAST QUARTER; THENCE WEST, ALONG A LINE BEING APPROXIMATELY 500 FEET NORTH OF AND PARALLEL TO THE SOUTH LINE OF THE SOUTHWEST QUARTER OF THE NORTHEAST QUARTER, TO A POINT ON THE EAST LINE OF THE SOUTHEAST QUARTER OF THE NORTHWEST QUARTER; THENCE NORTH, ALONG SAID EAST LINE OF THE SOUTHEAST QUARTER OF THE NORTHWEST QUARTER, TO THE NORTHEAST CORNER OF SAID SOUTHEAST QUARTER OF THE NORTHWEST QUARTER; THENCE WEST, ALONG THE NORTH LINE OF SAID SOUTHEAST QUARTER OF THE NORTHWEST QUARTER, TO THE NORTHWEST CORNER OF SAID SOUTHEAST QUARTER OF THE NORTHWEST QUARTER; THENCE SOUTH, ALONG THE WEST LINE OF SAID SOUTHEAST QUARTER OF THE NORTHWEST QUARTER, TO THE SOUTHWEST CORNER OF SAID SOUTHEAST QUARTER OF NORTHWEST QUARTER, THENCE WEST, ALONG THE SOUTH LINE OF THE NORTHWEST QUARTER, TO THE INTERSECTION OF THE EXTENSION OF THE SOUTH LINE OF THE NORTHWEST QUARTER AND THE WEST RIGHT-OF-WAY LINE OF SOUTH 37TH STREET; THENCE NORTH, ALONG SAID WEST RIGHT OF WAY LINE OF SOUTH 37TH STREET TO THE POINT OF BEGINNING.



LEGEND

- SECTION LINE
- PROPOSED ANNEX
- _____ PARCEL LINE

PROJECT NO: 020-3297
DRAWN BY: SR
DATE: 06/17/2021

ANNEXATION EXHIBIT

EXHIBIT
1.6