

DWG: F:\2020\3001-3500\020-3297\40-Design\Survey\SRV\Xref\XRAY\_0203297.dwg  
 DATE: Jun 23, 2021 2:32pm  
 USER: lwheeler  
 XREFS: V\_RWAY\_SPM\_72521 Norfolk-BASE

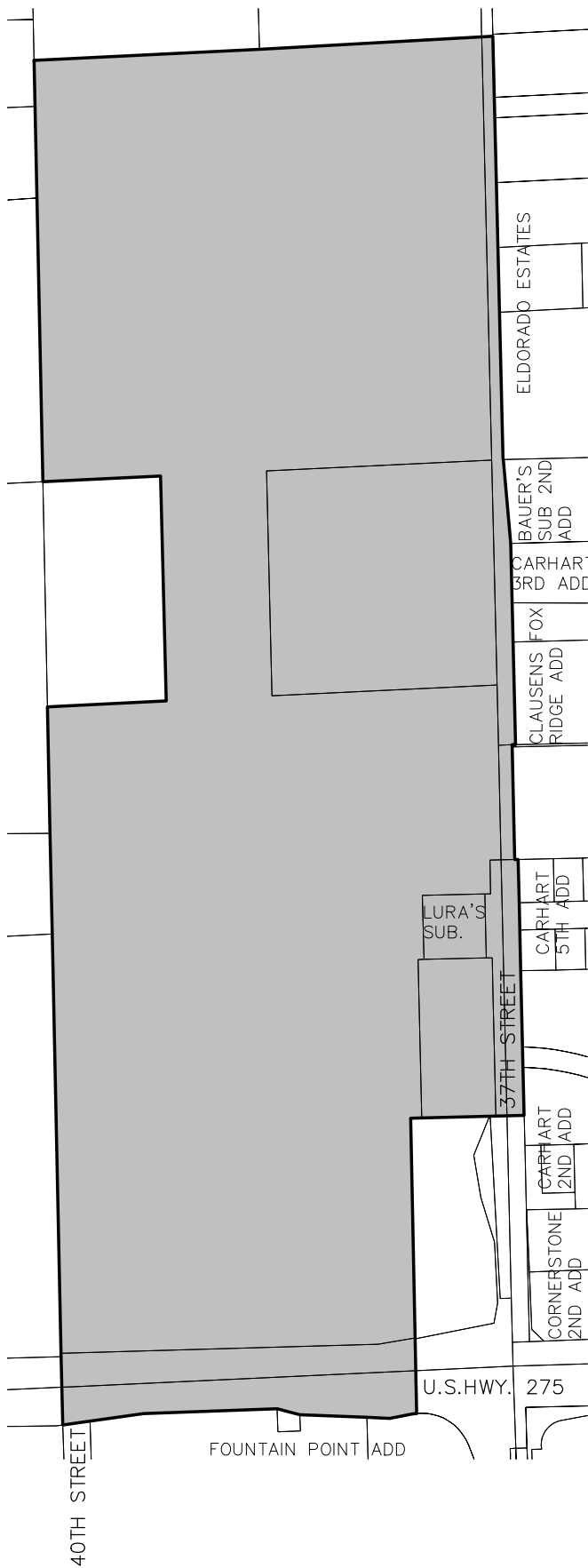

**LEGAL DESCRIPTION**

A TRACT OF LAND IN PART OF SECTIONS NINETEEN (19), TWENTY (20), AND THIRTY (30), ALL IN TOWNSHIP TWENTY-FOUR (24) NORTH, RANGE ONE (1) WEST OF THE 6TH P.M., NORFOLK, MADISON COUNTY, NEBRASKA AND MORE PARTICULARLY DESCRIBED AS;  
 BEGINNING AT THE INTERSECTION OF THE SAID EAST RIGHT OF WAY LINE OF NORTH 37TH STREET AND THE NORTH LINE OF A TRACT OF LAND RECORDED IN BOOK 2017, PAGE 00756, MADISON COUNTY REGISTER OF DEEDS; THENCE WEST, ALONG SAID NORTH LINE OF A TRACT OF LAND, TO A POINT APPROXIMATELY 660' NORTH OF THE NORTH RIGHT OF WAY LINE OF HIGHWAY 275 / WEST NORFOLK AVENUE AND 283' WEST OF THE EAST SECTION LINE SAID POINT ALSO BEING THE NORTHWEST CORNER OF SAID TRACT OF LAND; THENCE SOUTH, ALONG THE WEST LINE OF SAID TRACT OF LAND, TO THE INTERSECTION OF THE EXTENSION OF SAID WEST LINE OF A TRACT OF LAND AND THE SOUTH RIGHT-OF-WAY LINE OF HIGHWAY 275/ WEST NORFOLK AVENUE; THENCE WEST, ALONG SAID SOUTH RIGHT-OF-WAY LINE OF HWY 275/ WEST NORFOLK AVENUE, TO THE INTERSECTION OF THE WEST RIGHT OF WAY LINE OF 40TH STREET AND SAID SOUTH RIGHT OF WAY LINE OF HIGHWAY 275 / WEST NORFOLK AVENUE; THENCE NORTH, ALONG SAID WEST RIGHT OF WAY LINE OF 40TH STREET AND THE WEST LINE OF SAID EAST HALF OF THE SOUTHEAST QUARTER, TO A POINT ON SAID WEST LINE OF THE EAST HALF OF THE SOUTHEAST QUARTER APPROXIMATELY 1896 FEET NORTH OF THE NORTH RIGHT OF WAY LINE OF HIGHWAY 275 / WEST NORFOLK AVENUE SAID POINT ALSO BEING THE SOUTHWEST CORNER OF A TRACT OF LAND RECORDED IN BOOK M88-12, PAGE 571, MADISON COUNTY REGISTER OF DEEDS; THENCE EAST, ALONG A LINE 660' SOUTH OF AND PARALLEL TO THE NORTH LINE OF THE SOUTHEAST QUARTER SAID LINE ALSO BEING THE SOUTH LINE OF SAID TRACT OF LAND, TO THE SOUTHEAST CORNER OF SAID TRACT OF LAND; THENCE NORTH, ALONG THE EAST LINE OF SAID TRACT OF LAND ALSO BEING A LINE 330 FEET EAST OF AND PARALLEL TO THE WEST LINE OF THE EAST HALF OF THE SOUTHEAST QUARTER, TO THE NORTHEAST CORNER OF SAID TRACT OF LAND ALSO BEING A POINT ON THE NORTH LINE OF THE SOUTHEAST QUARTER APPROXIMATELY 660 FEET EAST OF THE NORTHWEST CORNER OF THE EAST HALF OF THE SOUTHEAST QUARTER; THENCE WEST, ALONG SAID NORTH OF THE SOUTHEAST QUARTER, TO THE NORTHWEST CORNER OF SAID EAST HALF OF THE SOUTHEAST QUARTER; THENCE NORTH, ALONG THE WEST LINE OF THE EAST HALF OF THE NORTHEAST QUARTER, TO A POINT ON THE WEST LINE OF THE EAST HALF OF THE NORTHEAST QUARTER APPROXIMATELY 1242 FEET NORTH OF THE NORTHWEST CORNER OF THE EAST HALF OF THE SOUTHEAST QUARTER SAID POINT ALSO BEING THE NORTHWEST CORNER OF A TRACT OF LAND RECORDED IN BOOK 2019, PAGE 04730, MADISON COUNTY REGISTER OF DEEDS; THENCE EAST, ALONG THE NORTH LINE OF SAID TRACT OF LAND, TO THE INTERSECTION OF THE EXTENSION OF THE NORTH LINE OF SAID TRACT OF LAND AND THE EAST RIGHT-OF-WAY LINE OF NORTH 37TH STREET; THENCE SOUTH, ALONG SAID EAST RIGHT OF WAY LINE OF NORTH 37TH STREET TO THE POINT OF BEGINNING.

**LEGEND**

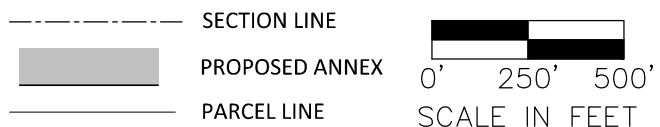

PROJECT NO: 020-3297  
 DRAWN BY: SR  
 DATE: 06/17/2021

**ANNEXATION EXHIBIT**

EXHIBIT  
**2.9**